

General Notes

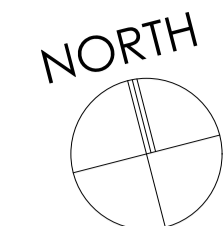

THIS DRAWING HAS BEEN PREPARED FROM SURVEY INFORMATION SUPPLIED BY OTHERS AND IS FOR INFORMATION PURPOSES ONLY. DO NOT SCALE FROM DRAWING. USE FIGURED DIMENSIONS ONLY.

© WAKE MORLEY ARCHITECTS LIMITED 2024. THIS DRAWING AND ITS CONTENTS HAS BEEN PRODUCED FOR THE CLIENT ONLY AND IS NOT INTENDED FOR ANY OTHER PERSON OR FOR ANY OTHER PURPOSE THAN THE DRAWING STATED. NO PART OF THIS DRAWING AND ASSOCIATED GRAPHICAL CONTENTS MAY BE REPRODUCED, COPIED, MODIFIED, ADAPTED OR DISTRIBUTED, WITHOUT THE PRIOR WRITTEN CONSENT OF THE AUTHOR.

ALL DIMENSIONS MUST BE CHECKED AND VERIFIED ON SITE PRIOR TO COMMENCEMENT OF WORK AND ARCHITECT TO BE NOTIFIED OF ANY DISCREPANCIES.

THE PARTY WALL ETC ACT 1996 CAME INTO FORCE ON 1ST JULY 1997 THROUGHOUT ENGLAND & WALES. IF YOU INTEND TO CARRY OUT BUILDING WORK WHICH INVOLVES ONE OF THE FOLLOWING CATEGORIES:

- WORK ON AN EXISTING WALL OR STRUCTURE SHARED WITH ANOTHER PROPERTY (SECTION 2 OF THE ACT)
- BUILDING A FREE STANDING WALL OR WALLS OF A BUILDING UP TO OR ABOVE THE BOUNDARY WITH A NEIGHBOURING PROPERTY (SECTION 1 OF THE ACT)
- EXCAVATING NEAR A NEIGHBOURING BUILDING (SECTION 6 OF THE ACT)

YOU MUST FIND OUT WHETHER THAT WORK FALLS WITHIN THE ACT (YOUR PROJECT MANAGER WILL BE ABLE TO ADVISE YOU ON THIS). IF IT DOES, YOU MUST NOTIFY ALL AFFECTED NEIGHBOURS. A NOTICE MUST BE GIVEN EVEN WHERE THAT WORK WILL NOT EXTEND BEYOND THE CENTRE LINE OF A PARTY WALL.

ALL CONSTRUCTION PROJECTS, COMMERCIAL OR DOMESTIC, ARE SUBJECT TO THE CDM REGULATIONS (2015). IT IS THE RESPONSIBILITY OF THE CLIENT TO ENSURE THAT WHERE MORE THAN ONE CONTRACTOR IS INVOLVED IN THE PROJECT THAT A PRINCIPAL DESIGNER IS APPOINTED TO UNDERTAKE CDM RESPONSIBILITIES ON THEIR BEHALF. ANY PROJECT REQUIRING MORE THAN 30 DAYS WORK AND 20 OR MORE WORKERS ON SITE SIMULTANEOUSLY AT ANY GIVEN TIME, OR WHICH REQUIRES MORE THAN 500 WORKING MAN HOURS MUST BE NOTIFIED BY THE CLIENT TO THE HSE USING AN F10 NOTIFICATION PRIOR TO WORK COMMENCING ON SITE.

BEFORE STARTING WORK YOU NEED TO CHECK IF ANY ASBESTOS IS PRESENT IN COMMERCIAL PROPERTIES THERE SHOULD BE A PLAN REGISTER ASK TO SEE IT. YOU NEED TO CHECK THAT THE PLAN COVERS THE AREA OF THE BUILDING THAT YOU WILL BE WORKING IN AND IF YOU ARE DOING REFURBISHMENT WORK THAT IT INCLUDES A SURVEY THAT TELLS YOU WHAT TYPES OF ASBESTOS IS PRESENT AND ITS CONDITION. IF THERE IS NO REGISTER OR SURVEY OR THE REPORT IS NOT CLEAR-DO NOT START WORK.

NO WORKS ARE TO START ON SITE PRIOR TO DISCHARGE OF ANY / ALL PRE-START PLANNING CONDITIONS.

THE CLIENT IS AT RISK IF ANY WORKS ARE STARTED PRIOR TO APPROVAL BY APPOINTED BUILDING CONTROL BODY.

Key Plan

GIA Ground Floor			
Unit Number	Unit Type	Podium/Patio Access	Area (sq ft)
A5.00.05	2 Bed w E/S	N	797.2
A6.00.01	2 Bed w E/S	Y	781.5
A6.00.02	2 Bed w E/S	Y	677.6
A6.00.03	2 Bed w E/S	Y	682.3
A6.00.04	2 Bed w E/S	Y	685.5
5			3,624.1 ft²



Revisions

Rev	Description	Dw	Chk	Date
C06	Wardrobes added	AM		22/08/2024
GF	partitions revised to 90mm	AM		23/04/2024
C05	studwork	AM		23/04/2024
	Window details updated, plans	AM		23/04/2024
C04	revised to suit	TM	AM	29/01/2024
	Re-design following fire rating	AM		16/11/2023
C03	changes to JH revised report	AM		01/09/2023
C02	Updated	AM		06/04/2023
C01	Construction Issue	AM		06/04/2023
	WIP updates to columns &	AM		07/11/2022
P02	gridlines	AM		16/09/2022
P01	WIP updates	AM		16/09/2022

Rev Description Dw Chk Date

Drawing Status: **CONSTRUCTION**

Client: **INVESTIN PLC (RELTON PROPERTY INVESTMENTS)**

Project: **PHASE 1b RESIDENTIAL DEVELOPMENT, BRISTOL STREET, BIRMINGHAM**

Drawing: **GROUND FLOOR PLAN**

Project No: 1637 1B Drawing No: 02_01_C06

Scale: B/A1 Date: FEB '22 Drawn by: AM Checked by:



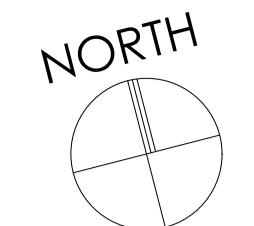

THIS DRAWING HAS BEEN PREPARED FROM SURVEY INFORMATION SUPPLIED BY OTHERS AND IS FOR INFORMATION PURPOSES ONLY. DO NOT SCALE FROM DRAWING. USE INDICATED DIMENSIONS ONLY.

© WAKE MORLEY ARCHITECTS LIMITED 2024. THIS DRAWING AND ITS CONTENTS HAS BEEN PRODUCED FOR THE CLIENT ONLY AND IS NOT INTENDED FOR ANY OTHER PERSON OR FOR ANY OTHER PURPOSE THAN THE DRAWING STATUS. NO PART OF THIS DRAWING AND ASSOCIATED GRAPHICAL CONTENTS MAY BE REPRODUCED, COPIED, MODIFIED, ADAPTED OR DISTRIBUTED, WITHOUT THE PRIOR WRITTEN CONSENT OF THE AUTHOR.

ALL DIMENSIONS MUST BE CHECKED AND VERIFIED ON SITE PRIOR TO COMMENCEMENT OF WORK AND ARCHITECT TO BE NOTIFIED OF ANY DISCREPANCIES.

THE PARTY WALL ETC ACT 1996 CAME INTO FORCE ON 1ST JULY 1997 THROUGHOUT ENGLAND & WALES. IF YOU INTEND TO CARRY OUT BUILDING WORK WHICH INVOLVES ONE OF THE FOLLOWING CATEGORIES:
 • WORK ON AN EXISTING WALL OR STRUCTURE SHARED WITH ANOTHER PROPERTY (SECTION 2 OF THE ACT)
 • BUILDING A FREE STANDING WALL OR WALLS OF A BUILDING UP TO OR ACROSS THE BOUNDARY WITH A NEIGHBOURING PROPERTY (SECTION 1 OF THE ACT)
 • EXCAVATING NEAR A NEIGHBOURING BUILDING (SECTION 6 OF THE ACT)
 YOU MUST FIND OUT WHETHER THAT WORK FALLS WITHIN THE ACT (YOUR PROJECT MANAGER WILL BE ABLE TO ADVISE YOU ON THIS). IF IT DOES, YOU MUST NOTIFY ALL AFFECTED NEIGHBOURS. A NOTICE MUST BE GIVEN EVEN WHERE THAT WORK WILL NOT EXTEND BEYOND THE CENTRE LINE OF A PARTY WALL.

ALL CONSTRUCTION PROJECTS, COMMERCIAL OR DOMESTIC, ARE SUBJECT TO THE CDM REGULATIONS (2015). IT IS THE RESPONSIBILITY OF THE CLIENT TO ENSURE THAT WHERE MORE THAN ONE CONTRACTOR IS INVOLVED IN THE PROJECT THAT A PRINCIPAL DESIGNER IS APPOINTED TO UNDERTAKE CDM RESPONSIBILITIES ON THEIR BEHALF. ANY PROJECT REQUIRING MORE THAN 30 DAYS WORK AND 20 OR MORE WORKERS ON SITE SIMULTANEOUSLY AT ANY GIVEN TIME, OR WHICH REQUIRES MORE THAN 500 WORKING MAN HOURS MUST BE NOTIFIED BY THE CLIENT TO THE HSE USING AN F10 NOTIFICATION PRIOR TO WORK COMMENCING ON SITE.

BEFORE STARTING WORK YOU NEED TO CHECK IF ANY ASBESTOS IS PRESENT IN COMMERCIAL PROPERTIES THERE SHOULD BE A PLAN/REGISTER ASK TO SEE IT. YOU NEED TO CHECK THAT THE PLAN COVERS THE AREA OF THE BUILDING THAT YOU WILL BE WORKING IN AND IF YOU ARE DOING REFURBISHMENT WORK THAT IT INCLUDES A SURVEY THAT TELLS YOU WHAT TYPES OF ASBESTOS IS PRESENT AND ITS CONDITION. IF THERE IS NO REGISTER OR SURVEY OR THE REPORT IS NOT CLEAR DO NOT START WORK.

NO WORKS ARE TO START ON SITE PRIOR TO DISCHARGE OF ANY / ALL PRE-START PLANNING CONDITIONS.

THE CLIENT IS AT RISK IF ANY WORKS ARE STARTED PRIOR TO APPROVAL BY APPOINTED BUILDING CONTROL BODY.

Key Plan

GIA First Floor			
Unit Number	Unit Type	Podium/Patio Access	Area (sq ft)
A4.01.01	2 Bed w E/S	N	693.8
A4.01.02	1 Bed	N	465.1
A4.01.03	2 Bed w E/S	N	684.2
A4.01.04	1 Bed	N	458.5
A4.01.05	1 Bed	N	457.9
A4.01.06	2 Bed w E/S	N	683.8
A4.01.07	2 Bed w E/S	N	767.9
A4.01.08	2 Bed w E/S	N	753.7
A4.01.09	1 Bed	Y	466.5
A4.01.10	2 Bed w E/S	Y	683.8
A4.01.11	1 Bed	Y	463.5
A4.01.12	2 Bed w E/S	Y	694.6
A5.01.01	2 Bed w E/S	N	682.3
A5.01.02	2 Bed w E/S	N	681.5
A5.01.03	2 Bed w E/S	N	681.5
A5.01.04	2 Bed w E/S	N	680.1
A5.01.05	2 Bed w E/S	N	747.8
A5.01.06	2 Bed w E/S	N	700.6
A5.01.07	2 Bed w E/S	Y	706.9
A5.01.08	2 Bed w E/S	Y	686.8
A5.01.09	2 Bed w E/S	Y	681.1
A6.01.01	2 Bed w E/S	Y	693.8
A6.01.02	1 Bed	Y	467.6
A6.01.03	2 Bed w E/S	Y	680.5
A6.01.04	1 Bed	Y	465.6
A6.01.05	2 Bed w E/S	N	680.4
A6.01.06	2 Bed w E/S	N	682.7
A6.01.07	2 Bed w E/S	N	683.1
A6.01.08	2 Bed w E/S	N	694.6
29			18,570.2 ft²

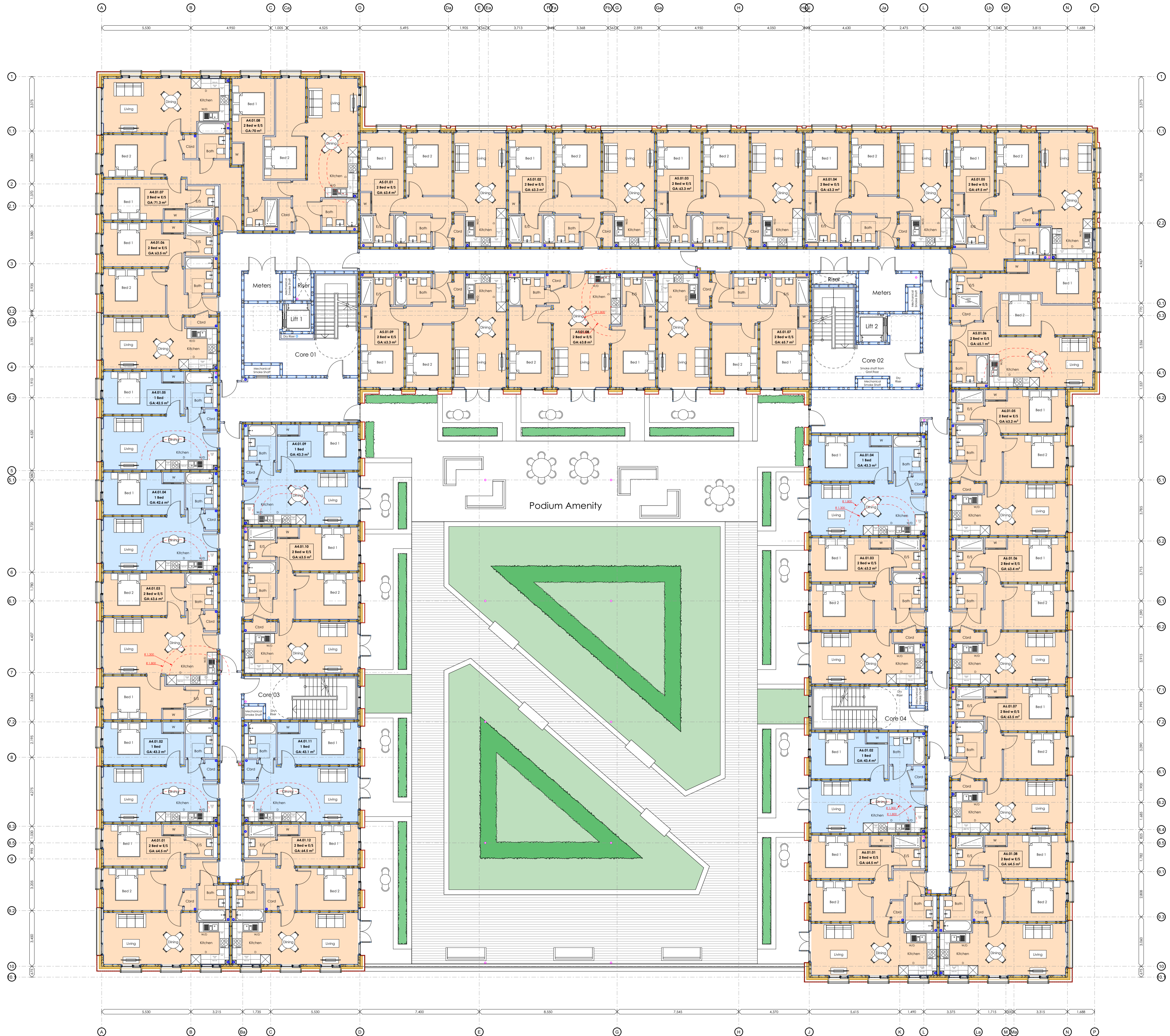

Revisions

Rev	Description	Dw	Chk	Date
C04	Wardrobes added, partitions	AM		22/08/2024
C03	Window details updated, plans revised to suit	TM	AM	29/01/2024
C02	Redesign following fire rating	AM		16/11/2023
C01	Change to JH revised report	AM		16/11/2023
C00	Construction Issue	AM		06/04/2023
P02	WIP updates to columns & gridlines	AM		07/11/2022
P01	WIP updates	AM		16/09/2022

Rev Description Dw Chk Date

Drawing Status: CONSTRUCTION

Client: INVESTIN PIC (RELTON PROPERTY INVESTMENTS),
 Project: PHASE 1b RESIDENTIAL DEVELOPMENT, BRISTOL STREET, BIRMINGHAM

Drawing: FIRST FLOOR PLAN.
 Project No: 1637 1B
 Scale: B01
 Date: FEB '22
 AM

Drawing No: 02_02_C04
 Date: FEB '22
 AM



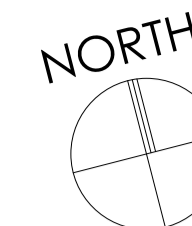

THIS DRAWING HAS BEEN PREPARED FROM SURVEY INFORMATION SUPPLIED BY OTHERS AND IS FOR INFORMATION PURPOSES ONLY. DO NOT SCALE FROM DRAWING. USE INDICATED DIMENSIONS ONLY.

© WAKE MORLEY ARCHITECTS LIMITED 2024. THIS DRAWING AND ITS CONTENTS HAS BEEN PRODUCED FOR THE CLIENT ONLY AND IS NOT INTENDED FOR ANY OTHER PERSON OR FOR ANY OTHER PURPOSE THAN THE DRAWING STATUS. NO PART OF THIS DRAWING AND ASSOCIATED GRAPHICAL CONTENTS MAY BE REPRODUCED, COPIED, MODIFIED, ADAPTED OR DISTRIBUTED, WITHOUT THE PRIOR WRITTEN CONSENT OF THE AUTHOR.

ALL DIMENSIONS MUST BE CHECKED AND VERIFIED ON SITE PRIOR TO COMMENCEMENT OF WORK AND ARCHITECT TO BE NOTIFIED OF ANY DISCREPANCIES.

THE PARTY WALL ETC ACT 1996 CAME INTO FORCE ON 1ST JULY 1997 THROUGHOUT ENGLAND & WALES. IF YOU INTEND TO CARRY OUT BUILDING WORK WHICH INVOLVES ONE OF THE FOLLOWING CATEGORIES:

- WORK ON AN EXISTING WALL OR STRUCTURE SHARED WITH ANOTHER PROPERTY (SECTION 2 OF THE ACT)
- BUILDING A FREE STANDING WALL OR WALLS OF A BUILDING UP TO OR ABOVE THE BOUNDARY WITH A NEIGHBOURING PROPERTY (SECTION 1 OF THE ACT)
- EXCAVATING NEAR A NEIGHBOURING BUILDING (SECTION 6 OF THE ACT)

YOU MUST FIND OUT WHETHER THAT WORK FALLS WITHIN THE ACT (YOUR PROJECT MANAGER WILL BE ABLE TO ADVISE YOU ON THIS). IF IT DOES, YOU MUST NOTIFY ALL AFFECTED NEIGHBOURS. A NOTICE MUST BE GIVEN EVEN WHERE THAT WORK WILL NOT EXTEND BEYOND THE CENTRE LINE OF A PARTY WALL.

ALL CONSTRUCTION PROJECTS, COMMERCIAL OR DOMESTIC, ARE SUBJECT TO THE CDM REGULATIONS (2015). IT IS THE RESPONSIBILITY OF THE CLIENT TO ENSURE THAT WHERE MORE THAN ONE CONTRACTOR IS INVOLVED IN THE PROJECT THAT A PRINCIPAL DESIGNER IS APPOINTED TO UNDERTAKE CDM RESPONSIBILITIES ON THEIR BEHALF. ANY PROJECT REQUIRING MORE THAN 30 DAYS WORK AND 20 OR MORE WORKERS ON SITE SIMULTANEOUSLY AT ANY GIVEN TIME, OR WHICH REQUIRES MORE THAN 500 WORKING MAN HOURS MUST BE NOTIFIED BY THE CLIENT TO THE HSE USING AN F10 NOTIFICATION PRIOR TO WORK COMMENCING ON SITE.

BEFORE STARTING WORK YOU NEED TO CHECK IF ANY ASBESTOS IS PRESENT IN COMMERCIAL PROPERTIES THERE SHOULD BE A PLAN/REGISTER ASK TO SEE IT. YOU NEED TO CHECK THAT THE PLAN COVERS THE AREA OF THE BUILDING THAT YOU WILL BE WORKING IN AND IF YOU ARE DOING REFURBISHMENT WORK THAT IT INCLUDES A SURVEY THAT TELLS YOU WHAT TYPES OF ASBESTOS IS PRESENT AND ITS CONDITION. IF THERE IS NO REGISTER OR SURVEY OR THE REPORT IS NOT CLEAR DO NOT START WORK.

NO WORKS ARE TO START ON SITE PRIOR TO DISCHARGE OF ANY / ALL PRE-START PLANNING CONDITIONS.

THE CLIENT IS AT RISK IF ANY WORKS ARE STARTED PRIOR TO APPROVAL BY APPOINTED BUILDING CONTROL BODY.

Key Plan

GIA Second Floor			
Unit Number	Unit Type	Podium/Patio Access	Area (sq ft)
A4.02.01	2 Bed w E/S	N	693.8
A4.02.02	1 Bed	N	465.1
A4.02.03	2 Bed w E/S	N	684.2
A4.02.04	1 Bed	N	458.5
A4.02.05	1 Bed	N	457.9
A4.02.06	2 Bed w E/S	N	683.8
A4.02.07	2 Bed w E/S	N	767.9
A4.02.08	2 Bed w E/S	N	753.7
A4.02.09	2 Bed w E/S	N	684.1
A4.02.10	2 Bed w E/S	N	683.8
A4.02.11	1 Bed	N	463.5
A4.02.12	2 Bed w E/S	N	694.6
A5.02.01	2 Bed w E/S	N	682.3
A5.02.02	2 Bed w E/S	N	681.5
A5.02.03	2 Bed w E/S	N	681.5
A5.02.04	2 Bed w E/S	N	680.1
A5.02.05	2 Bed w E/S	N	747.8
A5.02.06	2 Bed w E/S	N	700.9
A5.02.07	2 Bed w E/S	N	706.9
A5.02.08	2 Bed w E/S	N	686.8
A5.02.09	2 Bed w E/S	N	681.1
A6.02.01	2 Bed w E/S	N	693.8
A6.02.02	1 Bed	N	467.6
A6.02.03	2 Bed w E/S	N	680.5
A6.02.04	2 Bed w E/S	N	671.9
A6.02.05	2 Bed w E/S	N	680.4
A6.02.06	2 Bed w E/S	N	682.7
A6.02.07	2 Bed w E/S	N	683.1
A6.02.08	2 Bed w E/S	N	694.6
29			18,994.4 ft²

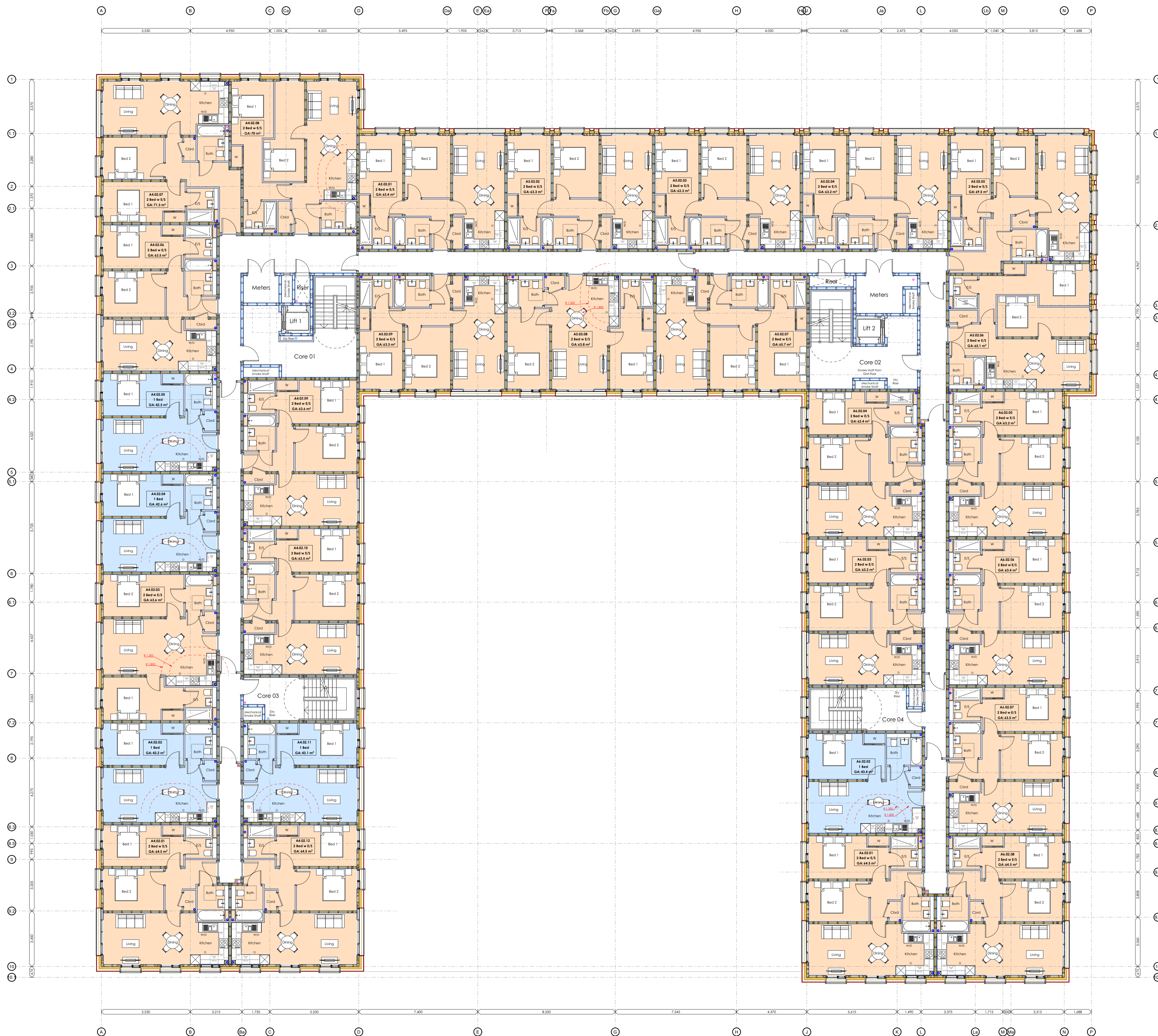

Revisions

Rev	Description	Dw	Chk	Date
Wardrobes added, partitions	AM			22/08/2024
C06 updated	AM			22/08/2024
Window details updated, plans	TM	AM		29/01/2024
Redesign following fire rating	AM			16/11/2023
CD4 change to JH revised report	AM			17/08/2023
C03 Removing Balconies	TM	AM		31/05/2023
C02 Balconies added	AM			06/04/2023
C01 Construction Issue	AM			07/11/2022
WIP updates to columns &	AM			16/09/2022
P02 gridlines	AM			07/11/2022
P01 WIP updates	AM			16/09/2022

CONSTRUCTION

Client:
INVESTIN PLC
(RELTON PROPERTY INVESTMENTS).

Project:
PHASE 1b RESIDENTIAL DEVELOPMENT,
BRISTOL STREET,
BIRMINGHAM

Drawing:
SECOND FLOOR PLAN.

Project No: 1637 1B
Scale: B/A1
Date: FEB '22
Drawing No: 02_03_C06
Down by: AM
Checked by:



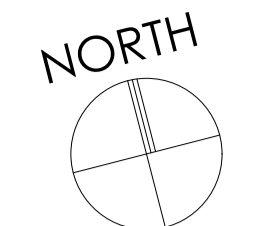

THIS DRAWING HAS BEEN PREPARED FROM SURVEY INFORMATION SUPPLIED BY OTHERS AND IS FOR INFORMATION PURPOSES ONLY. DO NOT SCALE FROM DRAWING. USE INDICATED DIMENSIONS ONLY.

© WAKE MORLEY ARCHITECTS LIMITED 2024. THIS DRAWING AND ITS CONTENTS HAS BEEN PRODUCED FOR THE CLIENT ONLY AND IS NOT INTENDED FOR ANY OTHER PERSON OR FOR ANY OTHER PURPOSE THAN THE DRAWING STATUS. NO PART OF THIS DRAWING AND ASSOCIATED GRAPHICAL CONTENTS MAY BE REPRODUCED, COPIED, MODIFIED, ADAPTED OR DISTRIBUTED, WITHOUT THE PRIOR WRITTEN CONSENT OF THE AUTHOR.

ALL DIMENSIONS MUST BE CHECKED AND VERIFIED ON SITE PRIOR TO COMMENCEMENT OF WORK AND ARCHITECT TO BE NOTIFIED OF ANY DISCREPANCIES.

THE PARTY WALL ETC ACT 1996 CAME INTO FORCE ON 1ST JULY 1997 THROUGHOUT ENGLAND & WALES. IF YOU INTEND TO CARRY OUT BUILDING WORK WHICH INVOLVES ONE OF THE FOLLOWING CATEGORIES:
 • WORK ON AN EXISTING WALL OR STRUCTURE SHARED WITH ANOTHER PROPERTY (SECTION 2 OF THE ACT)
 • BUILDING A FREE STANDING WALL OR WALLS OF A BUILDING UP TO OR ABOVE THE BOUNDARY WITH A NEIGHBOURING PROPERTY (SECTION 1 OF THE ACT)
 • EXCAVATING NEAR A NEIGHBOURING BUILDING (SECTION 6 OF THE ACT)
 YOU MUST FIND OUT WHETHER THAT WORK FALLS WITHIN THE ACT (YOUR PROJECT MANAGER WILL BE ABLE TO ADVISE YOU ON THIS). IF IT DOES, YOU NEED TO NOTIFY ALL AFFECTED NEIGHBOURS. A NOTICE MUST BE GIVEN EVEN WHERE THAT WORK WILL NOT EXTEND BEYOND THE CENTRE LINE OF A PARTY WALL.

ALL CONSTRUCTION PROJECTS, COMMERCIAL OR DOMESTIC, ARE SUBJECT TO THE CDM REGULATIONS (2015). IT IS THE RESPONSIBILITY OF THE CLIENT TO ENSURE THAT WHERE MORE THAN ONE CONTRACTOR IS INVOLVED IN THE PROJECT THAT A PRINCIPAL DESIGNER IS APPOINTED TO UNDERTAKE CDM RESPONSIBILITIES ON THEIR BEHALF. ANY PROJECT REQUIRING MORE THAN 30 DAYS WORK AND 20 OR MORE WORKERS ON SITE SIMULTANEOUSLY AT ANY GIVEN TIME, OR WHICH REQUIRES MORE THAN 500 WORKING HOURS MUST BE NOTIFIED BY THE CLIENT TO THE HSE USING AN F10 NOTIFICATION PRIOR TO WORK COMMENCING ON SITE.

BEFORE STARTING WORK YOU NEED TO CHECK IF ANY ASBESTOS IS PRESENT IN COMMERCIAL PROPERTIES THERE SHOULD BE A PLAN/REGISTER ASK TO SEE IT. YOU NEED TO CHECK THAT WHERE THE PLAN COVERS THE AREA OF THE BUILDING THAT YOU WILL BE WORKING IN AND IF YOU ARE DOING REFURBISHMENT WORK THAT IT INCLUDES A SURVEY THAT TELLS YOU WHAT TYPES OF ASBESTOS IS PRESENT AND ITS CONDITION. IF THERE IS NO REGISTER OR SURVEY OR THE REPORT IS NOT CLEAR DO NOT START WORK.

NO WORKS ARE TO START ON SITE PRIOR TO DISCHARGE OF ANY / ALL PRE-START PLANNING CONDITIONS.

THE CLIENT IS AT RISK IF ANY WORKS ARE STARTED PRIOR TO APPROVAL BY APPOINTED BUILDING CONTROL BODY.

Key Plan

GIA Third Floor			
Unit Number	Unit Type	Podium/Patio Access	Area (sq ft)
A4.03.01	2 Bed w E/S	N	693.8
A4.03.02	1 Bed	N	465.1
A4.03.03	2 Bed w E/S	N	684.2
A4.03.04	1 Bed	N	458.5
A4.03.05	1 Bed	N	457.9
A4.03.06	2 Bed w E/S	N	683.8
A4.03.07	2 Bed w E/S	N	767.9
A4.03.08	2 Bed w E/S	N	753.7
A4.03.09	2 Bed w E/S	N	683.0
A4.03.10	2 Bed w E/S	N	683.8
A4.03.11	1 Bed	N	463.5
A4.03.12	2 Bed w E/S	N	694.6
A5.03.01	2 Bed w E/S	N	682.3
A5.03.02	2 Bed w E/S	N	681.5
A5.03.03	2 Bed w E/S	N	681.5
A5.03.04	2 Bed w E/S	N	680.1
A5.03.05	2 Bed w E/S	N	747.8
A5.03.06	2 Bed w E/S	N	700.6
A5.03.07	2 Bed w E/S	N	706.9
A5.03.08	2 Bed w E/S	N	686.8
A5.03.09	2 Bed w E/S	N	681.1
A6.03.01	2 Bed w E/S	N	694.6
A6.03.02	1 Bed	N	467.6
A6.03.03	2 Bed w E/S	N	680.5
A6.03.04	2 Bed w E/S	N	671.9
A6.03.05	2 Bed w E/S	N	680.4
A6.03.06	2 Bed w E/S	N	682.7
A6.03.07	2 Bed w E/S	N	683.1
A6.03.08	2 Bed w E/S	N	694.6
29			18,993.8 ft²

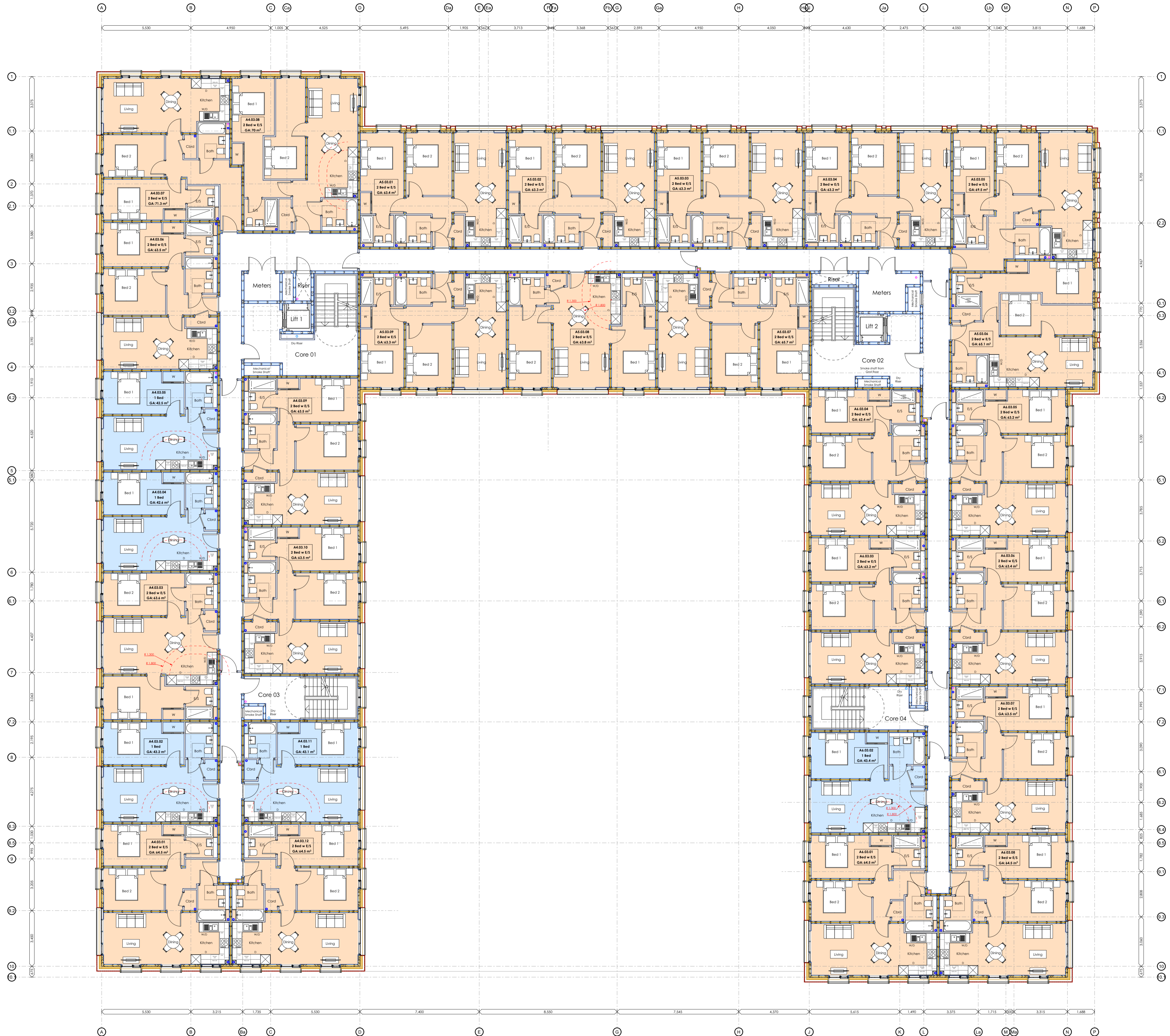

Revisions

Rev	Description	Dw	Chk	Date
Wardrobes added, partitions	AM	-	-	22/08/2024
C06 updated	AM	-	-	22/08/2024
C05 updated	AM	-	-	22/08/2024
Window details updated, plans revised to suit	TM	AM	-	29/01/2024
Redesign following fire rating	AM	-	-	17/08/2023
C04 change to JH revised report	AM	-	-	16/11/2023
C03 Removing Balconies	TM	AM	-	17/08/2023
C02 Balconies added	AM	-	-	31/05/2023
C01 Construction Issue	AM	-	-	06/04/2023
WIP updates to columns & F02 gridlines	AM	-	-	07/11/2022
WIP updates	AM	-	-	16/09/2022

Drawing Status

Client: INVESTIN PLC (RELTON PROPERTY INVESTMENTS).

Project: PHASE 1b RESIDENTIAL DEVELOPMENT, BRISTOL STREET, BIRMINGHAM

Drawing: THIRD FLOOR PLAN.

Project No: 1637 1B
 Drawing No: 02_04_C06
 Scale: B01
 Date: FEB '22
 AM



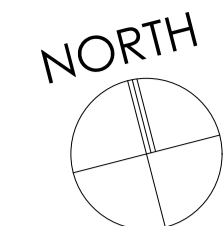

THIS DRAWING HAS BEEN PREPARED FROM SURVEY INFORMATION SUPPLIED BY OTHERS AND IS FOR INFORMATION PURPOSES ONLY. DO NOT SCALE FROM DRAWING. USE INDICATED DIMENSIONS ONLY.

© WAKE MORLEY ARCHITECTS LIMITED 2024. THIS DRAWING AND ITS CONTENTS HAS BEEN PRODUCED FOR THE CLIENT ONLY AND IS NOT INTENDED FOR ANY OTHER PERSON OR FOR ANY OTHER PURPOSE THAN THE DRAWING STATUS. NO PART OF THIS DRAWING AND ASSOCIATED GRAPHICAL CONTENTS MAY BE REPRODUCED, COPIED, MODIFIED, ADAPTED OR DISTRIBUTED, WITHOUT THE PRIOR WRITTEN CONSENT OF THE AUTHOR.

ALL DIMENSIONS MUST BE CHECKED AND VERIFIED ON SITE PRIOR TO COMMENCEMENT OF WORK AND ARCHITECT TO BE NOTIFIED OF ANY DISCREPANCIES.

THE PARTY WALL ETC ACT 1996 CAME INTO FORCE ON 1ST JULY 1997 THROUGHOUT ENGLAND & WALES. IF YOU INTEND TO CARRY OUT BUILDING WORK WHICH INVOLVES ONE OF THE FOLLOWING CATEGORIES:

- WORK ON AN EXISTING WALL OR STRUCTURE SHARED WITH ANOTHER PROPERTY (SECTION 2 OF THE ACT)
- BUILDING A FREE STANDING WALL OR WALLS OF A BUILDING UP TO OR ABOVE THE BOUNDARY WITH A NEIGHBOURING PROPERTY (SECTION 1 OF THE ACT)
- EXCAVATING NEAR A NEIGHBOURING BUILDING (SECTION 6 OF THE ACT)

YOU MUST FIND OUT WHETHER THAT WORK FALLS WITHIN THE ACT (YOUR PROJECT MANAGER WILL BE ABLE TO ADVISE YOU ON THIS). IF IT DOES, YOU MUST NOTIFY ALL AFFECTED NEIGHBOURS. A NOTICE MUST BE GIVEN EVEN WHERE THAT WORK WILL NOT EXTEND BEYOND THE CENTRE LINE OF A PARTY WALL.

ALL CONSTRUCTION PROJECTS, COMMERCIAL OR DOMESTIC, ARE SUBJECT TO THE CDM REGULATIONS (2015). IT IS THE RESPONSIBILITY OF THE CLIENT TO ENSURE THAT WHERE MORE THAN ONE CONTRACTOR IS INVOLVED IN THE PROJECT THAT A PRINCIPAL DESIGNER IS APPOINTED TO UNDERTAKE CDM RESPONSIBILITIES ON THEIR BEHALF. ANY PROJECT REQUIRING MORE THAN 30 DAYS WORK AND 20 OR MORE WORKERS ON SITE SIMULTANEOUSLY AT ANY GIVEN TIME, OR WHICH REQUIRES MORE THAN 500 WORKING MAN HOURS MUST BE NOTIFIED BY THE CLIENT TO THE HSE USING AN F10 NOTIFICATION PRIOR TO WORK COMMENCING ON SITE.

BEFORE STARTING WORK YOU NEED TO CHECK IF ANY ASBESTOS IS PRESENT IN COMMERCIAL PROPERTIES THERE SHOULD BE A PLAN/REGISTER ASK TO SEE IT. YOU NEED TO CHECK THAT THE PLAN COVERS THE AREA OF THE BUILDING THAT YOU WILL BE WORKING IN AND IF YOU ARE DOING REFURBISHMENT WORK THAT IT INCLUDES A SURVEY THAT TELLS YOU WHAT TYPES OF ASBESTOS IS PRESENT AND ITS CONDITION. IF THERE IS NO REGISTER OR SURVEY OR THE REPORT IS NOT CLEAR DO NOT START WORK.

NO WORKS ARE TO START ON SITE PRIOR TO DISCHARGE OF ANY / ALL PRE-START PLANNING CONDITIONS.

THE CLIENT IS AT RISK IF ANY WORKS ARE STARTED PRIOR TO APPROVAL BY APPOINTED BUILDING CONTROL BODY.

Key Plan

GIA Fourth Floor			
Unit Number	Unit Type	Podium/Patio Access	Area (sq ft)
A4.04.01	2 Bed w E/S	N	693.8
A4.04.02	1 Bed	N	465.1
A4.04.03	2 Bed w E/S	N	684.2
A4.04.04	1 Bed	N	458.5
A4.04.05	1 Bed	N	457.9
A4.04.06	2 Bed w E/S	N	683.8
A4.04.07	2 Bed w E/S	N	767.9
A4.04.08	2 Bed w E/S	N	753.7
A4.04.09	2 Bed w E/S	N	683.0
A4.04.10	2 Bed w E/S	N	683.8
A4.04.11	1 Bed	N	463.5
A4.04.12	2 Bed w E/S	N	694.6
A5.04.01	2 Bed w E/S	N	682.3
A5.04.02	2 Bed w E/S	N	681.5
A5.04.03	2 Bed w E/S	N	681.5
A5.04.04	2 Bed w E/S	N	680.1
A5.04.05	2 Bed w E/S	N	747.8
A5.04.06	2 Bed w E/S	N	700.6
A5.04.07	2 Bed w E/S	N	706.9
A5.04.08	2 Bed w E/S	N	686.8
A5.04.09	2 Bed w E/S	N	681.1
A6.04.01	2 Bed w E/S	N	693.8
A6.04.02	1 Bed	N	467.6
A6.04.03	2 Bed w E/S	N	680.5
A6.04.04	2 Bed w E/S	N	671.9
A6.04.05	2 Bed w E/S	N	680.2
A6.04.06	2 Bed w E/S	N	682.7
A6.04.07	2 Bed w E/S	N	683.1
A6.04.08	2 Bed w E/S	N	694.6
29			18,992.8 ft²

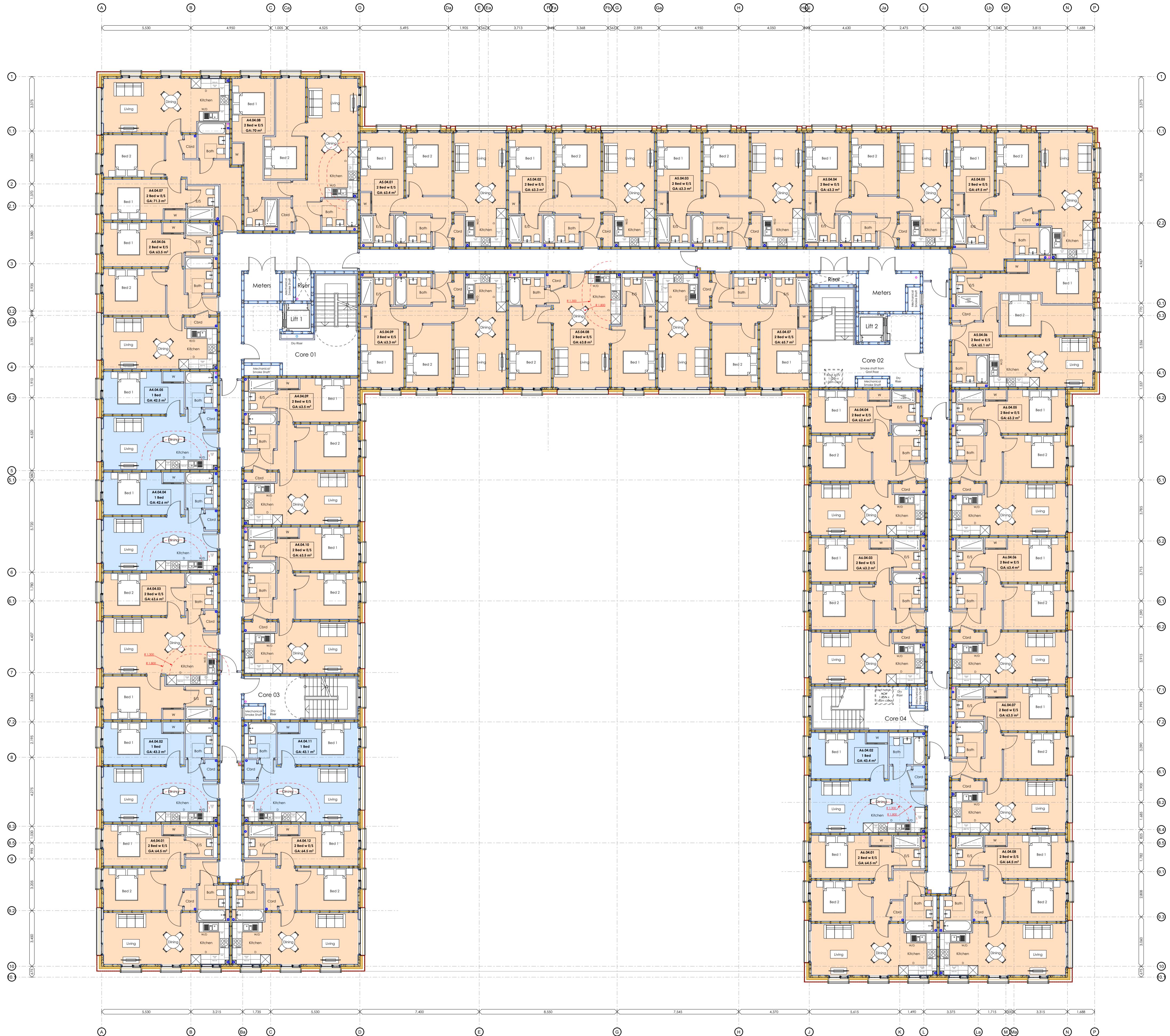

Revisions

Rev	Description	Dw	Chk	Date
CO6	Wardrobes added, partitions updated	AM		22/08/2024
CO5	Window details updated, plans revised to suit	TM	AM	29/01/2024
CO4	Redesign following fire rating change to JH revised report	AM		16/11/2023
CO3	Removing Balconies	TM	AM	17/08/2023
CO2	Balconies added	AM		31/05/2023
CO1	Construction Issue	AM		06/04/2023
	WIP updates to columns & F02 gridlines	AM		07/11/2022
	F01 WIP updates	AM		16/09/2022

CONSTRUCTION

Client: INVESTIN PLC (RELTON PROPERTY INVESTMENTS).
 Project: PHASE 1b RESIDENTIAL DEVELOPMENT, BRISTOL STREET, BIRMINGHAM
 Drawing: FOURTH FLOOR PLAN.

Project No: 1637 1B
 Drawing No: 02_05_CO6
 Scale: B/A1
 Date: FEB '22
 AM



General Notes

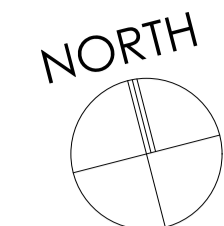

THIS DRAWING HAS BEEN PREPARED FROM SURVEY INFORMATION SUPPLIED BY OTHERS AND IS FOR INFORMATION PURPOSES ONLY. DO NOT SCALE FROM DRAWING. USE FIGURED DIMENSIONS ONLY.

© WAKE MORLEY ARCHITECTS LIMITED 2024. THIS DRAWING AND ITS CONTENTS HAS BEEN PRODUCED FOR THE CLIENT ONLY AND IS NOT INTENDED FOR ANY OTHER PERSON OR FOR ANY OTHER PURPOSE THAN THE DRAWING STATED. NO PART OF THIS DRAWING AND ASSOCIATED GRAPHICAL CONTENTS MAY BE REPRODUCED, COPIED, MODIFIED, ADAPTED OR DISTRIBUTED, WITHOUT THE PRIOR WRITTEN CONSENT OF THE AUTHOR.

ALL DIMENSIONS MUST BE CHECKED AND VERIFIED ON SITE PRIOR TO COMMENCEMENT OF WORK AND ARCHITECT TO BE NOTIFIED OF ANY DISCREPANCIES.

THE PARTY WALL ETC ACT 1996 CAME INTO FORCE ON 1ST JULY 1997 THROUGHOUT ENGLAND & WALES. IF YOU INTEND TO CARRY OUT BUILDING WORK WHICH INVOLVES ONE OF THE FOLLOWING CATEGORIES:

- WORK ON AN EXISTING WALL OR STRUCTURE SHARED WITH ANOTHER PROPERTY (SECTION 2 OF THE ACT)
- BUILDING A FREE STANDING WALL OR WALLS OF A BUILDING UP TO OR ABOVE THE BOUNDARY WITH A NEIGHBOURING PROPERTY (SECTION 1 OF THE ACT)
- EXCAVATING NEAR A NEIGHBOURING BUILDING (SECTION 6 OF THE ACT)

YOU MUST FIND OUT WHETHER THAT WORK FALLS WITHIN THE ACT (YOUR PROJECT MANAGER WILL BE ABLE TO ADVISE YOU ON THIS). IF IT DOES, YOU MUST NOTIFY ALL AFFECTED NEIGHBOURS. A NOTICE MUST BE GIVEN EVEN WHERE THAT WORK WILL NOT EXTEND BEYOND THE CENTRE LINE OF A PARTY WALL.

ALL CONSTRUCTION PROJECTS, COMMERCIAL OR DOMESTIC, ARE SUBJECT TO THE CDM REGULATIONS (2015). IT IS THE RESPONSIBILITY OF THE CLIENT TO ENSURE THAT WHERE MORE THAN ONE CONTRACTOR IS INVOLVED IN THE PROJECT THAT A PRINCIPAL DESIGNER IS APPOINTED TO UNDERTAKE CDM RESPONSIBILITIES ON THEIR BEHALF. ANY PROJECT REQUIRING MORE THAN 30 DAYS WORK AND 20 OR MORE WORKERS ON SITE SIMULTANEOUSLY AT ANY GIVEN TIME, OR WHICH REQUIRES MORE THAN 500 WORKING MAN HOURS MUST BE NOTIFIED BY THE CLIENT TO THE HSE USING AN F10 NOTIFICATION PRIOR TO WORK COMMENCING ON SITE.

BEFORE STARTING WORK YOU NEED TO CHECK IF ANY ASBESTOS IS PRESENT IN COMMERCIAL PROPERTIES THERE SHOULD BE A PLAN/REGISTER ASK TO SEE IT. YOU NEED TO CHECK THAT THE PLAN COVERS THE AREA OF THE BUILDING THAT YOU WILL BE WORKING IN AND IF YOU ARE DOING REFURBISHMENT WORK THAT IT INCLUDES A SURVEY THAT TELLS YOU WHAT TYPES OF ASBESTOS IS PRESENT AND ITS CONDITION. IF THERE IS NO REGISTER OR SURVEY OR THE REPORT IS NOT CLEAR DO NOT START WORK.

NO WORKS ARE TO START ON SITE PRIOR TO DISCHARGE OF ANY / ALL PRE-START PLANNING CONDITIONS.

THE CLIENT IS AT RISK IF ANY WORKS ARE STARTED PRIOR TO APPROVAL BY APPOINTED BUILDING CONTROL BODY.

Key Plan

GIA Fifth Floor			
Unit Number	Unit Type	Podium/Patio Access	Area (sq ft)
A4.05.01	2 Bed w E/S	N	693.8
A4.05.02	1 Bed	N	465.1
A4.05.03	2 Bed w E/S	N	684.2
A4.05.04	1 Bed	N	458.5
A4.05.05	1 Bed	N	457.9
A4.05.06	2 Bed w E/S	N	683.8
A4.05.07	2 Bed w E/S	N	767.9
A4.05.08	2 Bed w E/S	N	755.3
A4.05.09	2 Bed w E/S	N	683.0
A4.05.10	2 Bed w E/S	N	683.9
A4.05.11	1 Bed	N	463.5
A4.05.12	2 Bed w E/S	N	694.6
12			7,491.5 ft²

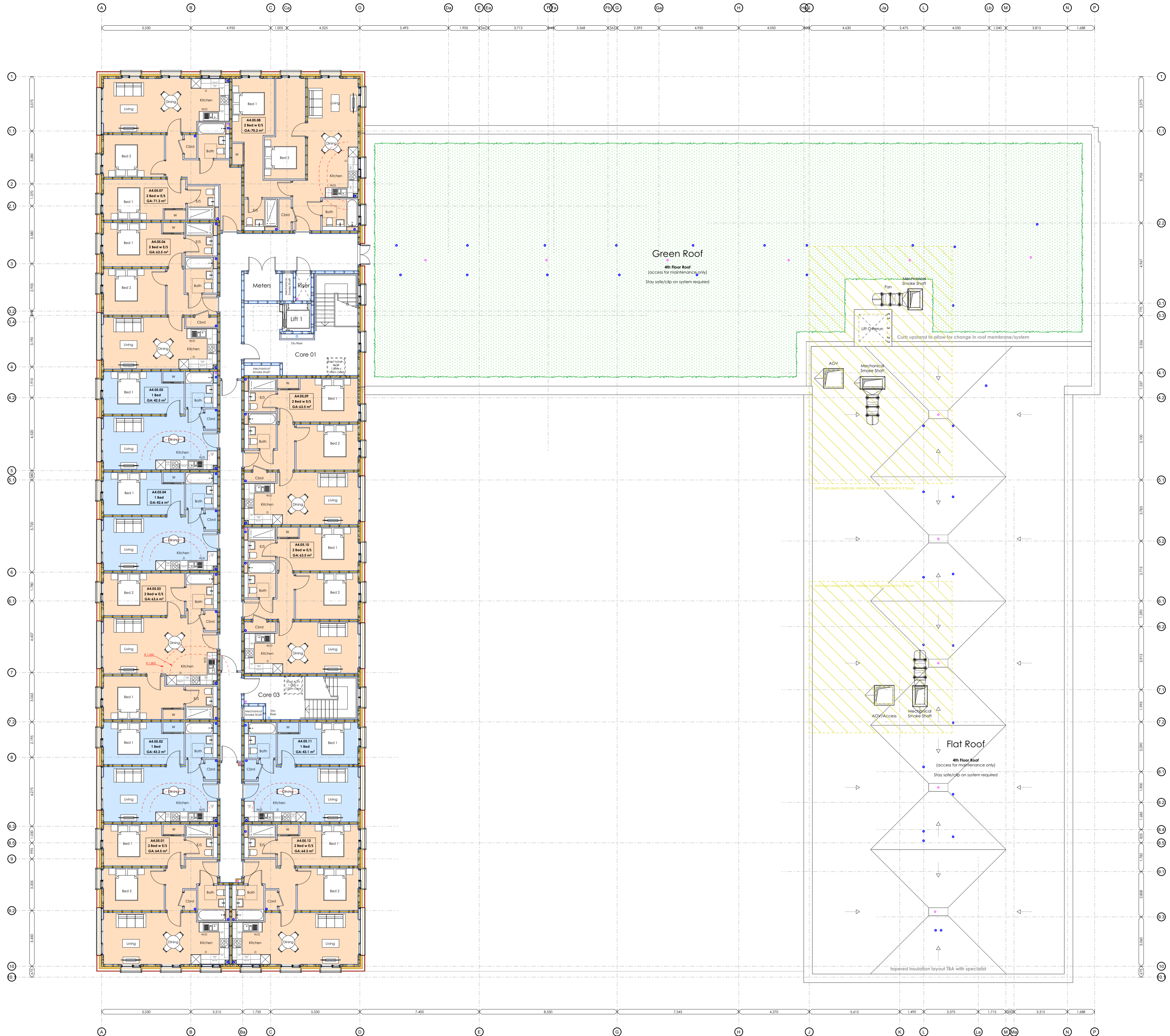

Revisions

Rev	Description	AM	TM	DM
Wardrobes added, partitions		AM		22/08/2024
C06 updated		AM		
Window details updated, plans		TM	AM	29/01/2024
C05 revised to suit		TM	AM	29/01/2024
Redesign following fire rating				
C04 change to JH revised report		AM		16/11/2023
C03 Removing Balconies		TM	AM	17/08/2023
C02 Balconies added		AM		31/05/2023
C01 Construction Issue		AM		06/04/2023
WIP updates to columns &				
P02 gridlines		AM		07/11/2022
P01 WIP updates		AM		16/09/2022

Rev Description Dw Chk Date

Drawing Status

CONSTRUCTION

Client: **INVESTIN PLC (RELTON PROPERTY INVESTMENTS).**

Project: **PHASE 1b RESIDENTIAL DEVELOPMENT, BRISTOL STREET, BIRMINGHAM**

Drawing: **FIFTH FLOOR PLAN.**

Project No: **1637 1B** Drawing No: **02_04_C06**

Scale: **B/A1** Date: **FEB '22** AM

Scale: **1:125** Date: **FEB '22** AM

Scale: **1:125** Date: **FEB '22** AM

Scale: **1:125** Date: **FEB '22** AM

Scale: **1:125** Date: **FEB '22** AM

Scale: **1:125** Date: **FEB '22** AM

Scale: **1:125** Date: **FEB '22** AM

Scale: **1:125** Date: **FEB '22** AM

Scale: **1:125** Date: **FEB '22** AM

Scale: **1:125** Date: **FEB '22** AM

Scale: **1:125** Date: **FEB '22** AM

Scale: **1:125** Date: **FEB '22** AM

Scale: **1:125** Date: **FEB '22** AM

Scale: **1:125** Date: **FEB '22** AM



Wake Morley Architects
RIBA #
Chartered Practice
Tel: 01484 461755
e: enquiry@wakemorleyarchitects.com
1 Dunford Road, Holmfirth, West Yorkshire HD9 2DP

Phase 1b GIA All Floors				
Floor	Unit Number	Unit Type	Podium/Patio Access	Area (sq ft)
Ground Floor	A5.00.05	2 Bed w E/S	N	797.2
	A6.00.01	2 Bed w E/S	Y	781.5
	A6.00.02	2 Bed w E/S	Y	677.6
	A6.00.03	2 Bed w E/S	Y	685.3
	A6.00.04	2 Bed w E/S	Y	685.5
5				3,624.1 #
First Floor	A4.01.01	2 Bed w E/S	N	693.8
	A4.01.02	1 Bed	N	465.1
	A4.01.03	2 Bed w E/S	N	684.2
	A4.01.04	1 Bed	N	458.5
	A4.01.05	1 Bed	N	457.9
	A4.01.06	2 Bed w E/S	N	683.8
	A4.01.07	2 Bed w E/S	N	767.9
	A4.01.08	2 Bed w E/S	N	753.7
	A4.01.09	1 Bed	Y	466.5
	A4.01.10	2 Bed w E/S	Y	683.8
	A4.01.11	1 Bed	Y	463.5
	A4.01.12	2 Bed w E/S	Y	694.6
	A5.01.01	2 Bed w E/S	N	682.3
	A5.01.02	2 Bed w E/S	N	681.5
	A5.01.03	2 Bed w E/S	N	681.5
	A5.01.04	2 Bed w E/S	N	680.1
	A5.01.05	2 Bed w E/S	N	747.8
	A5.01.06	2 Bed w E/S	N	700.6
	A5.01.07	2 Bed w E/S	Y	706.9
	A5.01.08	2 Bed w E/S	Y	686.8
	A5.01.09	2 Bed w E/S	Y	681.1
	A6.01.01	2 Bed w E/S	Y	693.8
	A6.01.02	1 Bed	Y	467.6
	A6.01.03	2 Bed w E/S	Y	680.5
	A6.01.04	1 Bed	Y	465.6
	A6.01.05	2 Bed w E/S	N	680.4
	A6.01.06	2 Bed w E/S	N	682.7
	A6.01.07	2 Bed w E/S	N	683.1
A6.01.08	2 Bed w E/S	N	694.6	
29				18,970.2 #
Second Floor	A4.02.01	2 Bed w E/S	N	693.8
	A4.02.02	1 Bed	N	465.1
	A4.02.03	2 Bed w E/S	N	684.2
	A4.02.04	1 Bed	N	458.5
	A4.02.05	1 Bed	N	457.9
	A4.02.06	2 Bed w E/S	N	683.8
	A4.02.07	2 Bed w E/S	N	767.9
	A4.02.08	2 Bed w E/S	N	753.7
	A4.02.09	2 Bed w E/S	N	684.1
	A4.02.10	2 Bed w E/S	N	683.8
	A4.02.11	1 Bed	N	463.5
	A4.02.12	2 Bed w E/S	N	694.6
	A5.02.01	2 Bed w E/S	N	682.3
	A5.02.02	2 Bed w E/S	N	681.5
	A5.02.03	2 Bed w E/S	N	681.5
	A5.02.04	2 Bed w E/S	N	680.1
	A5.02.05	2 Bed w E/S	N	747.8
	A5.02.06	2 Bed w E/S	N	700.9
	A5.02.07	2 Bed w E/S	N	706.9
	A5.02.08	2 Bed w E/S	N	686.8
	A5.02.09	2 Bed w E/S	N	681.1
	A6.02.01	2 Bed w E/S	N	693.8
	A6.02.02	1 Bed	N	467.6
	A6.02.03	2 Bed w E/S	N	680.5
	A6.02.04	2 Bed w E/S	N	671.9
	A6.02.05	2 Bed w E/S	N	680.4
	A6.02.06	2 Bed w E/S	N	682.7
	A6.02.07	2 Bed w E/S	N	683.1
A6.02.08	2 Bed w E/S	N	694.6	
29				18,994.4 #
Third Floor	A4.03.01	2 Bed w E/S	N	693.8
	A4.03.02	1 Bed	N	465.1
	A4.03.03	2 Bed w E/S	N	684.2
	A4.03.04	1 Bed	N	458.5
	A4.03.05	1 Bed	N	457.9
	A4.03.06	2 Bed w E/S	N	683.8
	A4.03.07	2 Bed w E/S	N	767.9
	A4.03.08	2 Bed w E/S	N	753.7
	A4.03.09	2 Bed w E/S	N	683.0
	A4.03.10	2 Bed w E/S	N	683.8
	A4.03.11	1 Bed	N	463.5
	A4.03.12	2 Bed w E/S	N	694.6
	A5.03.01	2 Bed w E/S	N	682.3
	A5.03.02	2 Bed w E/S	N	681.5
	A5.03.03	2 Bed w E/S	N	681.5
	A5.03.04	2 Bed w E/S	N	680.1
	A5.03.05	2 Bed w E/S	N	747.8
	A5.03.06	2 Bed w E/S	N	700.6
	A5.03.07	2 Bed w E/S	N	706.9
	A5.03.08	2 Bed w E/S	N	686.8
	A5.03.09	2 Bed w E/S	N	681.1
	A6.03.01	2 Bed w E/S	N	694.6
	A6.03.02	1 Bed	N	467.6
	A6.03.03	2 Bed w E/S	N	680.5
	A6.03.04	2 Bed w E/S	N	671.9
	A6.03.05	2 Bed w E/S	N	680.4
	A6.03.06	2 Bed w E/S	N	682.7
	A6.03.07	2 Bed w E/S	N	683.1
A6.03.08	2 Bed w E/S	N	694.6	
29				18,993.8 #
Fourth Floor	A4.04.01	2 Bed w E/S	N	693.8
	A4.04.02	1 Bed	N	465.1
	A4.04.03	2 Bed w E/S	N	684.2
	A4.04.04	1 Bed	N	458.5
	A4.04.05	1 Bed	N	457.9
	A4.04.06	2 Bed w E/S	N	683.8
	A4.04.07	2 Bed w E/S	N	767.9
	A4.04.08	2 Bed w E/S	N	753.7
	A4.04.09	2 Bed w E/S	N	683.0
	A4.04.10	2 Bed w E/S	N	683.8
	A4.04.11	1 Bed	N	463.5
	A4.04.12	2 Bed w E/S	N	694.6
	A5.04.01	2 Bed w E/S	N	682.3
	A5.04.02	2 Bed w E/S	N	681.5
	A5.04.03	2 Bed w E/S	N	681.5
	A5.04.04	2 Bed w E/S	N	680.1
	A5.04.05	2 Bed w E/S	N	747.8
	A5.04.06	2 Bed w E/S	N	700.6
	A5.04.07	2 Bed w E/S	N	706.9
	A5.04.08	2 Bed w E/S	N	686.8
	A5.04.09	2 Bed w E/S	N	681.1
	A6.04.01	2 Bed w E/S	N	693.8
	A6.04.02	1 Bed	N	467.6
	A6.04.03	2 Bed w E/S	N	680.5
	A6.04.04	2 Bed w E/S	N	671.9
	A6.04.05	2 Bed w E/S	N	680.2
	A6.04.06	2 Bed w E/S	N	682.7
	A6.04.07	2 Bed w E/S	N	683.1
A6.04.08	2 Bed w E/S	N	694.6	
29				18,992.8 #
Fifth Floor	A4.05.01	2 Bed w E/S	N	693.8
	A4.05.02	1 Bed	N	465.1
	A4.05.03	2 Bed w E/S	N	684.2
	A4.05.04	1 Bed	N	458.5
	A4.05.05	1 Bed	N	457.9
	A4.05.06	2 Bed w E/S	N	683.8
	A4.05.07	2 Bed w E/S	N	767.9
	A4.05.08	2 Bed w E/S	N	753.7
	A4.05.09	2 Bed w E/S	N	683.0
	A4.05.10	2 Bed w E/S	N	683.9
	A4.05.11	1 Bed	N	463.5
	A4.05.12	2 Bed w E/S	N	694.6
	12			
133				86,666.8 #

Schedule of Units Types	
Type	Measured Area
1 Bed	12,027.5
26	12,027.5 #
2 Bed w E/S	74,639.3
107	74,639.3 #
133	86,666.8 #

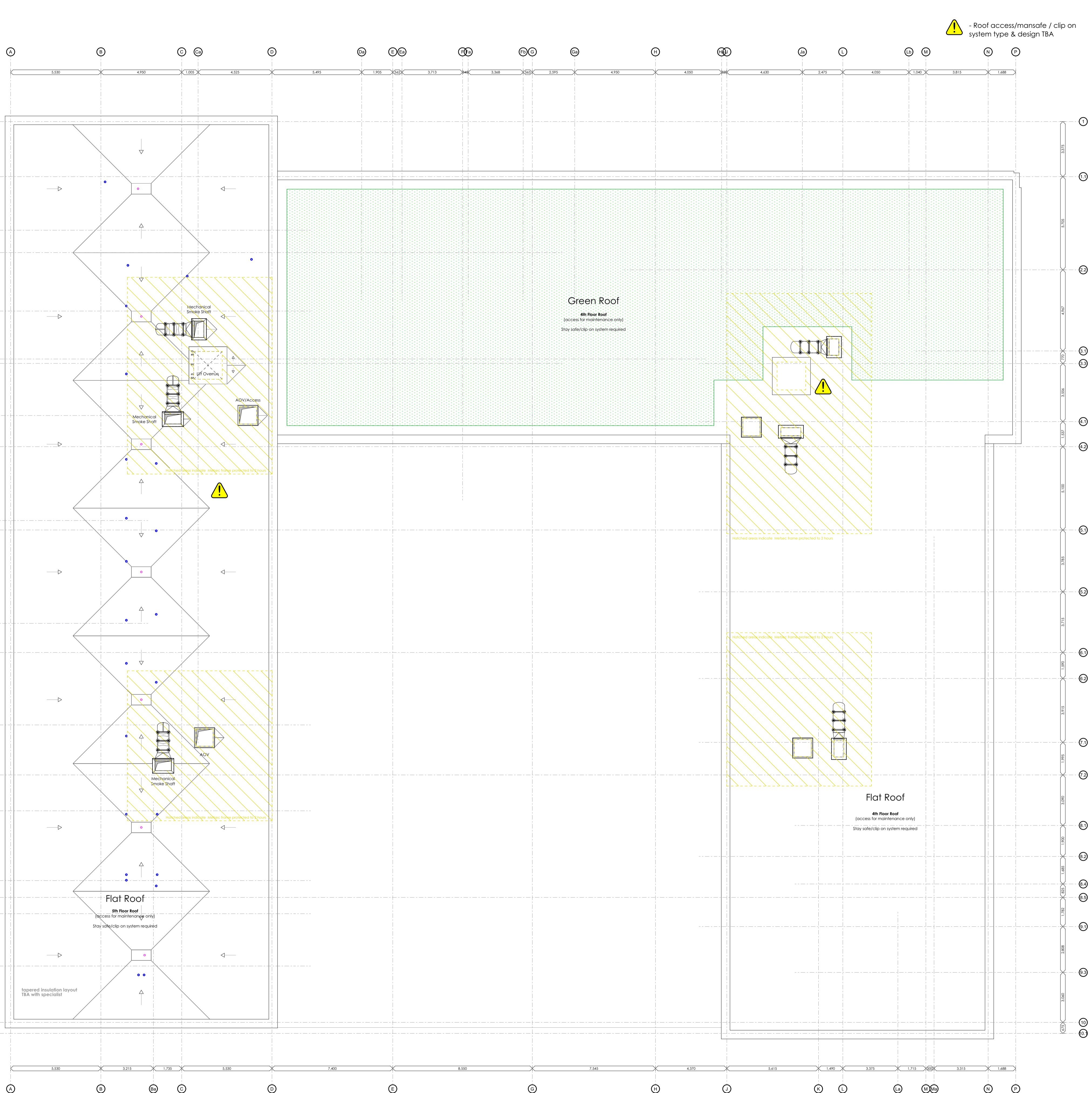

General Notes

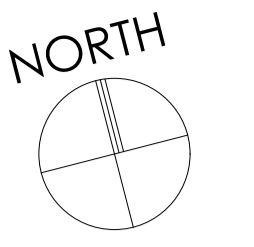

THIS DRAWING HAS BEEN PREPARED FROM SURVEY INFORMATION SUPPLIED BY OTHERS AND IS FOR INFORMATION PURPOSES ONLY. DO NOT SCALE FROM DRAWING. USE INDICATED DIMENSIONS ONLY.

© WAKE MORLEY ARCHITECTS LIMITED 2024. THIS DRAWING AND ITS CONTENTS HAS BEEN PRODUCED FOR THE CLIENT ONLY AND IS NOT INTENDED FOR ANY OTHER PERSON OR FOR ANY OTHER PURPOSE THAN THE DRAWING STATUS. NO PART OF THIS DRAWING AND ASSOCIATED GRAPHICAL CONTENTS MAY BE REPRODUCED, COPIED, MODIFIED, ADAPTED OR DISTRIBUTED, WITHOUT THE PRIOR WRITTEN CONSENT OF THE AUTHOR.

ALL DIMENSIONS MUST BE CHECKED AND VERIFIED ON SITE PRIOR TO COMMENCEMENT OF WORK AND ARCHITECT TO BE NOTIFIED OF ANY DISCREPANCIES.

THE PARTY WALL ETC ACT 1996 CAME INTO FORCE ON 1ST JULY 1997 THROUGHOUT ENGLAND & WALES. IF YOU INTEND TO CARRY OUT BUILDING WORK WHICH INVOLVES ONE OF THE FOLLOWING CATEGORIES:

- WORK ON AN EXISTING WALL OR STRUCTURE SHARED WITH ANOTHER PROPERTY (SECTION 2 OF THE ACT)
- BUILDING A FREE STANDING WALL OR WALLS OF A BUILDING UP TO OR ABOVE THE BOUNDARY WITH A NEIGHBOURING PROPERTY (SECTION 1 OF THE ACT)
- EXCAVATING NEAR A NEIGHBOURING BUILDING (SECTION 6 OF THE ACT)

YOU MUST FIND OUT WHETHER THAT WORK FALLS WITHIN THE ACT (YOUR PROJECT MANAGER WILL BE ABLE TO ADVISE YOU ON THIS). IF IT DOES, YOU MUST NOTIFY ALL AFFECTED NEIGHBOURS. A NOTICE MUST BE GIVEN EVEN WHERE THAT WORK WILL NOT EXTEND BEYOND THE CENTRE LINE OF A PARTY WALL.

ALL CONSTRUCTION PROJECTS, COMMERCIAL OR DOMESTIC, ARE SUBJECT TO THE CDM REGULATIONS (2015). IT IS THE RESPONSIBILITY OF THE CLIENT TO ENSURE THAT WHERE MORE THAN ONE CONTRACTOR IS INVOLVED IN THE PROJECT THAT A PRINCIPAL DESIGNER IS APPOINTED TO UNDERTAKE CDM RESPONSIBILITIES ON THEIR BEHALF. ANY PROJECT REQUIRING MORE THAN 30 DAYS WORK AND 20 OR MORE WORKERS ON SITE SIMULTANEOUSLY AT ANY GIVEN TIME, OR WHICH REQUIRES MORE THAN 500 WORKING HOURS MUST BE NOTIFIED BY THE CLIENT TO THE HSE USING AN F10 NOTIFICATION PRIOR TO WORK COMMENCING ON SITE.

BEFORE STARTING WORK YOU NEED TO CHECK IF ANY ASBESTOS IS PRESENT IN COMMERCIAL PROPERTIES THERE SHOULD BE A PLAN REGISTERED ASK TO SEE IT. YOU NEED TO CHECK THAT THE PLAN COVERS THE AREA OF THE BUILDING THAT YOU WILL BE WORKING IN AND IF YOU ARE DOING REFURBISHMENT WORK THAT IT INCLUDES A SURVEY THAT TELLS YOU WHAT TYPES OF ASBESTOS IS PRESENT AND ITS CONDITION. IF THERE IS NO REGISTER OR SURVEY OR THE REPORT IS NOT CLEAR DO NOT START WORK.

NO WORKS ARE TO START ON SITE PRIOR TO DISCHARGE OF ANY / ALL PRE-START PLANNING CONDITIONS.

THE CLIENT IS AT RISK IF ANY WORKS ARE STARTED PRIOR TO APPROVAL BY APPOINTED BUILDING CONTROL BODY.

Key Plan



Revisions

Rev	Description	Dw	Chk	Date
01	CD4 GIA schedules updated	AM		22/08/2024
02	GIA schedule Apt types	AM		27/03/2024
03	CD3 column added	AM		27/03/2024
04	Redesign following fire rating	AM		16/11/2023
05	CO2 change to JH revised report	AM		06/04/2023
06	CD1 Construction Issue	AM		06/04/2023
07	WIP updates to columns &	AM		07/11/2022
08	P02 gridlines	AM		16/09/2022
09	P01 WIP updates	AM		16/09/2022

Rev	Description	Dw	Chk	Date
10	CONSTRUCTION			

Client: INVESTIN PLC (RELTON PROPERTY INVESTMENTS).

Project: PHASE 1b RESIDENTIAL DEVELOPMENT, BRISTOL STREET, BIRMINGHAM

Drawing: ROOF PLAN.

Project No: 1637 1B
 Drawing No: 02_07 CD4
 Scale: B/A1
 Date: FEB '22
 AM

